

Extra Large
Board Model

3D AXI

AUTOMATED X-RAY INSPECTION

TR7600TL SIII SERIES

 Ultra-High Speed
3D CT X-Ray Inspection

 Ultimate Resolution AXI
for Large Boards

 Smart Programming with
Robust Algorithms

1200 x 660
mm mm
Large Board
Support

High Speed
Inspection

Smart Factory
Ready



TRI
innovation

Imaging System	Camera	Ultra-High Speed Line-Scan CCD Cameras (3 or 5 Units)			
	X-ray Source	130 kV Max (User Adjustable)			
	Imaging Resolution (User Selectable)	10 μ m*	15 μ m	20 μ m	25 μ m
	Inspection Method	2D, 2.5D, 3D Slicing, Planar CT (Optional)			
Inspection Functions	Component Defects	Missing, Misalignment, Tombstone, Billboard, Tantalum Polarity, Rotation and Floating			
	Solder Joint Defects	Insufficient/Excess Solder, Bridging, Open, Solder Ball, Non-Wetting, Void and Lifted Lead			
X-Y-Z-Axis Control		High-Precision Ballscrew + AC-Servo Controller			
X-Y-Z Axis Accuracy		1 μ m			
Max PCB Size	Standard	610 x 660 mm (24.02 x 25.98 in.)			
	2 Stages	1200 x 660 mm (47.24 x 25.98 in.)			
PCB Thickness		0.6 - 7 mm (0.02 - 0.28 in.)			
PCB Transport Height		880 - 920 mm (34.65 - 36.22 in.)			
Max PCB Weight		12 kg (26.46 lb.)			
PCB Carrier / Fixing		Step Motor Driven / Pneumatic Clamping			
Clearance	Top	15 mm (0.59 in.)	30 mm (1.18 in.)	50 mm (1.97 in.)	
	Bottom	70 mm (27.6 in.)		55 mm (2.17 in.)	
	Edge	3 mm (0.12 in.) or 5 mm (0.20 in.)			
Weight		4750 kg (10,471.96 lb)			
Power Requirement		200 - 240 VAC, Three Phase, 50 / 60 Hz, 7 kVA. Optional: 346 - 416 VAC Three Phase Transformer			
Air Requirement		72 psi - 87 psi (5 - 6 bar)			
Optional Features		Barcode Scanner, Repair Station, Offline Editor, Yield Management System (YMS 4.0), YMS Lite, CAD Converter and CT Imaging			

* For confirming the specific technical requirements, please contact TRI's sales representative

Unit: mm (in.)

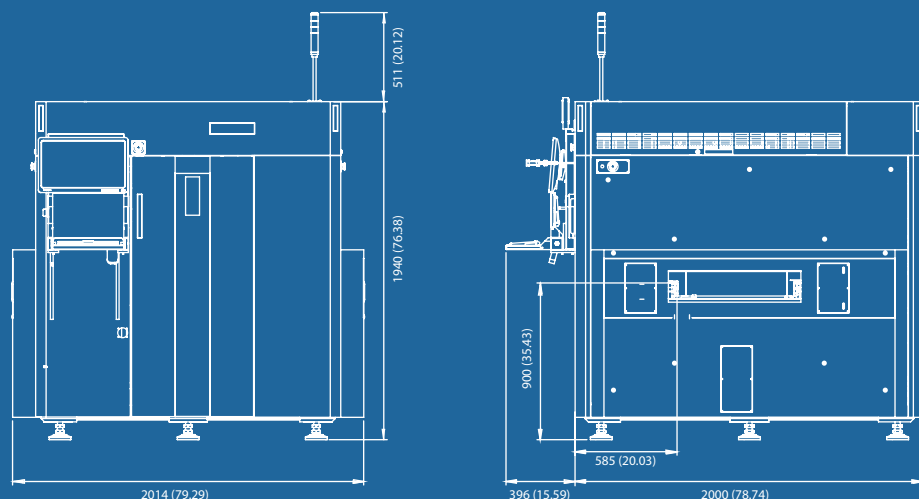

Global Network

Schwabach, Germany trieurope@tri.com.tw
San Jose, CA, USA triusa@tri.com.tw
Tokyo, Japan trijp@tri.com.tw
Ansan, Korea trikr@tri.com.tw

Shenzhen, China shenzhen@cn.tri.com.tw
Suzhou, China suzhou@cn.tri.com.tw
Penang, Malaysia trimy@tri.com.tw

HEADQUARTERS

7F., No.45, Dexing West Rd., Shilin Dist.,
 Taipei City 11158, Taiwan

+886-2-2832-8918 Sales@tri.com.tw

TRI 德律 TRI INNOVATION

© 2018 Test Research, Inc. All rights reserved.
 Specifications are subject to change.
 All other trademarks are the property of their respective owners.